

Fact Sheet Floors

The speed of building is a major advantage, which is gained by using large-format floor cassettes.

The floor cassettes come with a platform that accepts a layer of finish as soon as the building is weather tight. When this is coupled with a proper layer of overlay, the floor will have a solid and extremely stable feel.



The voids within floors can be used for ductwork, services and lightwells, keeping floors and ceilings neat and tidy and free from external fixings.

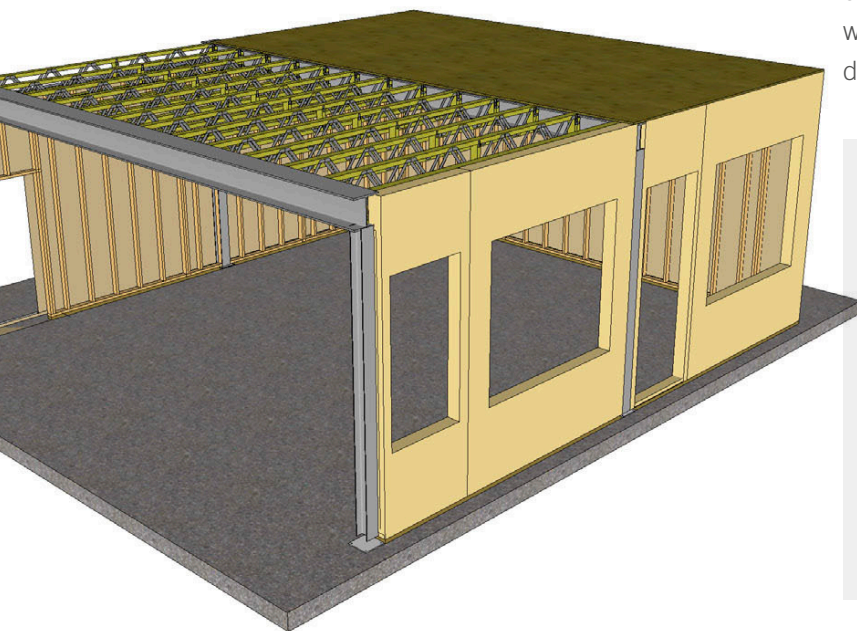

Floor span and performance capabilities are increased by using engineered joists, which mitigate against what is known as disproportionate collapse, where in the event of damage occurring to any part of the building, the extent of any resulting collapse will not be disproportionate to the cause of the damage.

Using i-SIPs mean that suspended ceilings, ventilation bulkheads and exposed drylined soffits can be easily integrated, depending on needs and the environmental approach taken.

